



Application Note

THIS INFORMATION PROVIDED BY AUTOMATIONDIRECT.COM TECHNICAL SUPPORT IS PROVIDED "AS IS" WITHOUT A GUARANTEE OF ANY KIND. These documents are provided by our technical support department to assist others. We do not guarantee that the data is suitable for your particular application, nor do we assume any responsibility for them in your application.

Product Family: C-More, Do-More, and Productivity **Number:** **KB-MISC-002**
Subject: **Google Gmail Functionality** **Date Issued:** **March 10, 2022**
Revision: **V1.0**

On May 30, 2022, Google will no longer support the use of third-party apps or devices which ask you to sign into your Google Account using only your username and password.

<https://support.google.com/accounts/answer/6010255?hl=en>

For devices that do not have 2-step verification, their solution is the implementation of the "App Password" feature, to allow other devices to still use Gmail.

<https://support.google.com/accounts/answer/185833>

You will have to generate a unique password for each of your devices that will use Gmail to send emails. If you don't register App Password in your Gmail account and generate unique passwords for your C-More, Productivity, of Do-More devices, then after May 30, 2022, your device will not be able to send emails through your Gmail account anymore.



Application Note

THIS INFORMATION PROVIDED BY AUTOMATIONDIRECT.COM TECHNICAL SUPPORT IS PROVIDED "AS IS" WITHOUT A GUARANTEE OF ANY KIND. These documents are provided by our technical support department to assist others. We do not guarantee that the data is suitable for your particular application, nor do we assume any responsibility for them in your application.

Updating your Gmail account

You will need to log into your Google account and generate a new password for each device that is using Gmail.

- 1) You will need to log into your Google account.

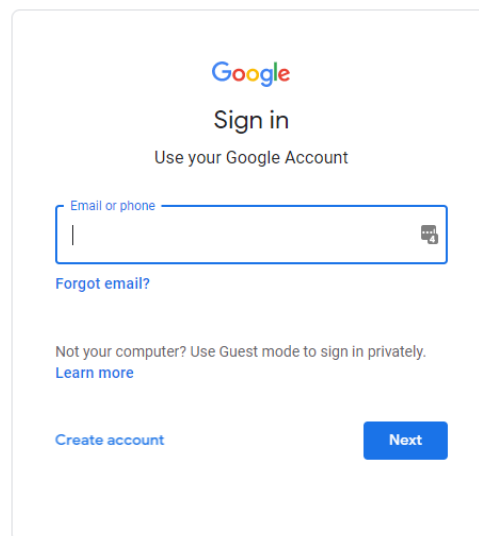

- 2) Once you are logged in, go to "Manage your Google Account"

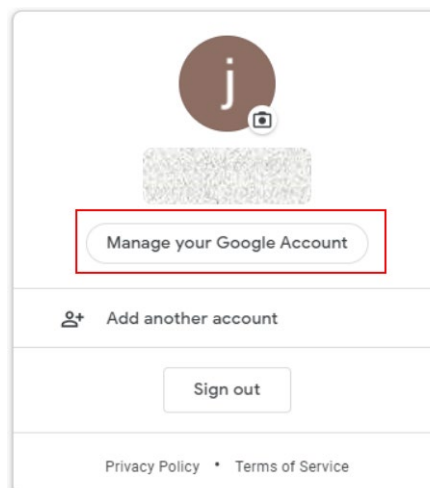

Technical Assistance: If you have questions regarding this Application Note, please contact [Technical Support](#) for further assistance.

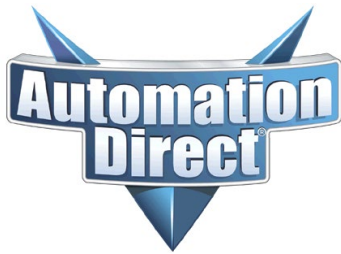

Application Note

THIS INFORMATION PROVIDED BY AUTOMATIONDIRECT.COM TECHNICAL SUPPORT IS PROVIDED "AS IS" WITHOUT A GUARANTEE OF ANY KIND. These documents are provided by our technical support department to assist others. We do not guarantee that the data is suitable for your particular application, nor do we assume any responsibility for them in your application.

3) In the Gmail Account, open Security

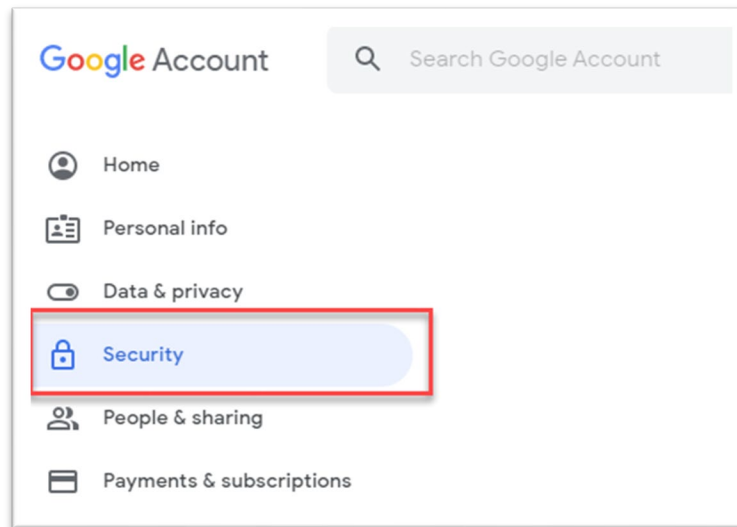

4) Enable 2-Step Verification

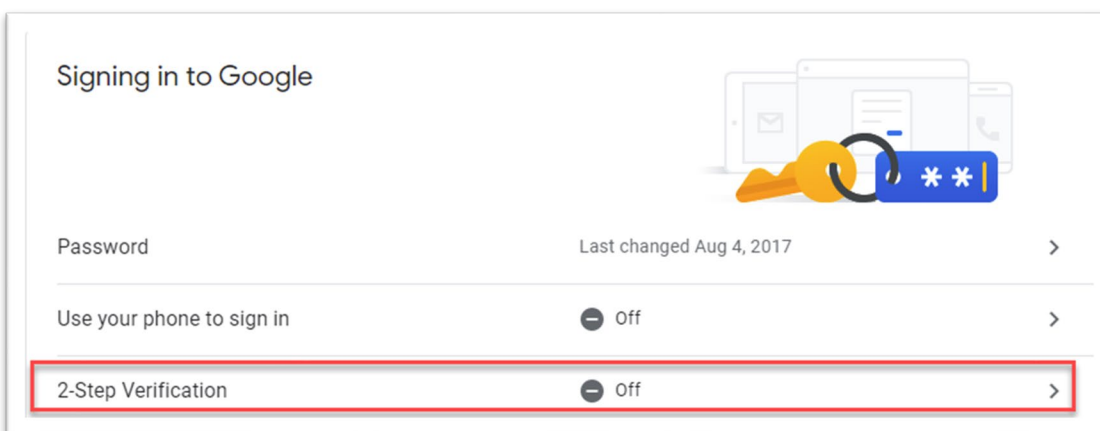

Follow all the 2-step verification steps. The 2-Step verification will only be necessary for setting up App Password.

Note: You will not have to use 2-step verification with the C-more, Do-More, or Productivity devices.

Technical Assistance: If you have questions regarding this Application Note, please contact [Technical Support](#) for further assistance.



Application Note

THIS INFORMATION PROVIDED BY AUTOMATIONDIRECT.COM TECHNICAL SUPPORT IS PROVIDED "AS IS" WITHOUT A GUARANTEE OF ANY KIND. These documents are provided by our technical support department to assist others. We do not guarantee that the data is suitable for your particular application, nor do we assume any responsibility for them in your application.

- 5) After 2-Step Verification has been enabled, there will be a selection for App Passwords available. Select App Password

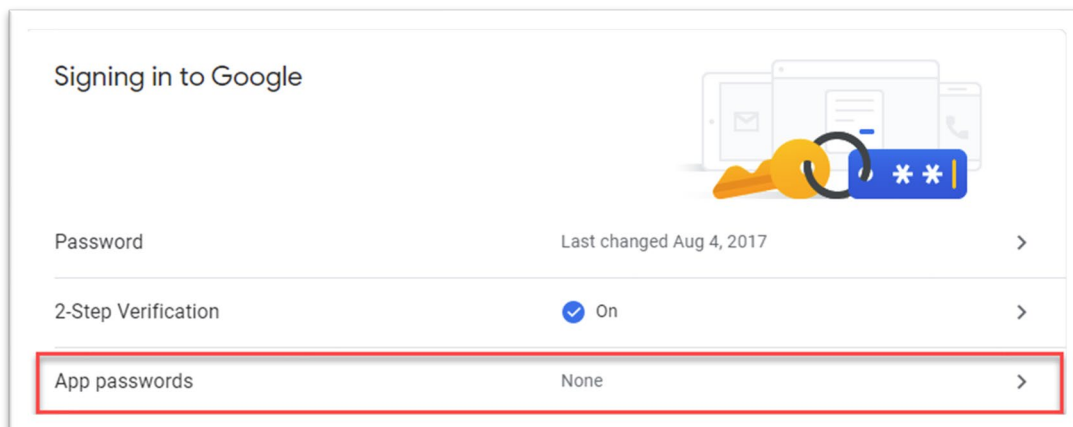

- 6) Select App and select Other (*Custom Name*)

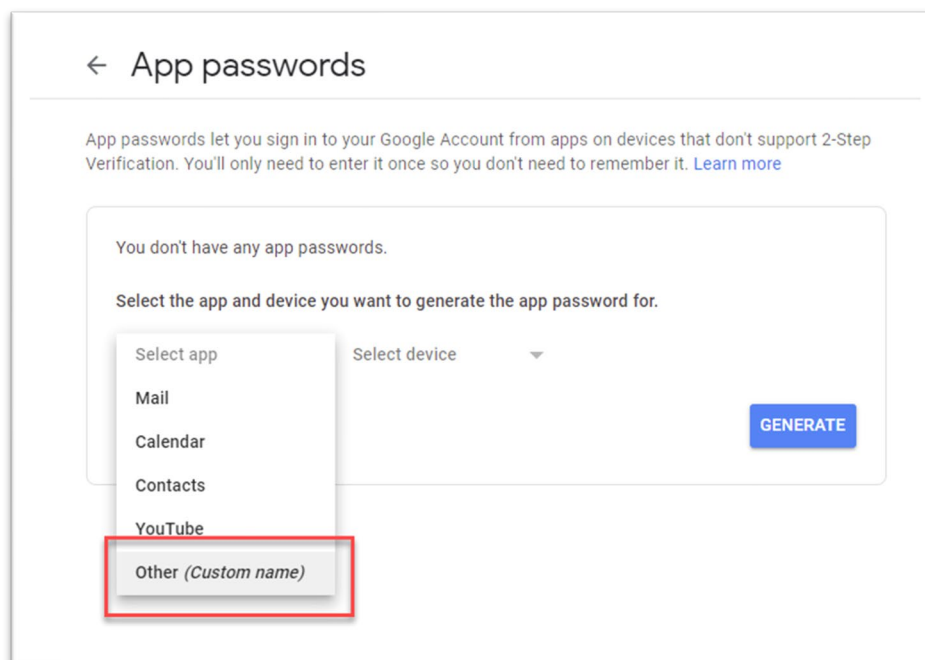



Application Note

THIS INFORMATION PROVIDED BY AUTOMATIONDIRECT.COM TECHNICAL SUPPORT IS PROVIDED "AS IS" WITHOUT A GUARANTEE OF ANY KIND. These documents are provided by our technical support department to assist others. We do not guarantee that the data is suitable for your particular application, nor do we assume any responsibility for them in your application.

7) Enter a Name for the App Password and select Generate

← App passwords

App passwords let you sign in to your Google Account from apps on devices that don't support 2-Step Verification. You'll only need to enter it once so you don't need to remember it. [Learn more](#)

You don't have any app passwords.

Select the app and device you want to generate the app password for.

C-more - 1|

Generated app password

Your app password for your device

oplt kjuy xhvd jqxm

How to use it

Go to the settings for your Google Account in the application or device you are trying to set up. Replace your password with the 16-character password shown above. Just like your normal password, this app password grants complete access to your Google Account. You won't need to remember it, so don't write it down or share it with anyone.

You need to create one App Password per device. If you have 3 devices, you need to create 3 separate App Passwords.

Technical Assistance: If you have questions regarding this Application Note, please contact [Technical Support](#) for further assistance.



Application Note

THIS INFORMATION PROVIDED BY AUTOMATIONDIRECT.COM TECHNICAL SUPPORT IS PROVIDED "AS IS" WITHOUT A GUARANTEE OF ANY KIND. These documents are provided by our technical support department to assist others. We do not guarantee that the data is suitable for your particular application, nor do we assume any responsibility for them in your application.

Updating the password in C-More, Do-More and Productivity

Use your Google-generated password in the "password" field for your device.

Note: Leave out the spaces

C-more Example

The screenshot shows the 'Email Client' configuration page in the Automation Direct web interface. The left sidebar contains navigation options: All, Panel Name, Ethernet Port, FTP Service, Email Client (selected), Web Server, and Remote Access. The main content area is titled 'Email Client' and contains three sections: 'Server Configuration', 'Encryption', and 'Authentication'.
- **Server Configuration:** Email Client Protocol is set to 'SMTP - Authenticated'. Mail Address (Sender) is 'adc.cmore.email@gmail.com'. Send Mail Server (SMTP) is 'smtp.gmail.com'. Port No. (SMTP) is '587'.
- **Encryption:** 'This Server Requires encryption' is checked. 'TLS (typically port no. 587)' is selected with a radio button. 'Use STARTTLS' is checked with a checkbox. 'SSL (typically port no. 465)' is unselected.
- **Authentication:** Account is 'adc.cmore.email@gmail.com'. The Password field is highlighted with a red border and has a callout bubble pointing to it that says 'App Password'.
The 'App Password' callout bubble is a yellow speech bubble with a tail pointing to the password field.



Application Note

THIS INFORMATION PROVIDED BY AUTOMATIONDIRECT.COM TECHNICAL SUPPORT IS PROVIDED "AS IS" WITHOUT A GUARANTEE OF ANY KIND. These documents are provided by our technical support department to assist others. We do not guarantee that the data is suitable for your particular application, nor do we assume any responsibility for them in your application.

Do-more/BRX Example

Edit SMTP Client Settings

Device Name:

SMTP Server Address

- Use Server Name
- Use IP Address

Account Authentication

- Disabled
- AUTH LOGIN
- AUTH PLAIN
- POP before SMTP POP3 Port:

Account Information

Username:

Password:

Security (only available on BRX platform)

- Enable SSL/TLS
 - TLS (usually port 587)
 - SSL (usually port 465)
- Disable Certificate Validation

Other Settings

Server Port:

Timeout: seconds

'From' Email Address:

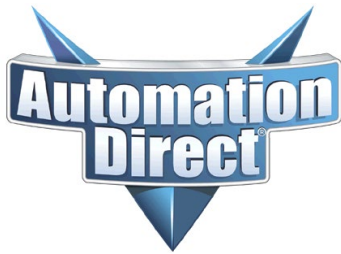

Application Note

THIS INFORMATION PROVIDED BY AUTOMATIONDIRECT.COM TECHNICAL SUPPORT IS PROVIDED "AS IS" WITHOUT A GUARANTEE OF ANY KIND. These documents are provided by our technical support department to assist others. We do not guarantee that the data is suitable for your particular application, nor do we assume any responsibility for them in your application.

Productivity Example

The screenshot shows the 'Gmail Properties' dialog box with the following settings:

- Account Name: adc.ps.email@gmail.com
- Service Name: smtp.gmail.com
- Encryption: STARTTLS
- Port Number: 587
- SMTP Server Response Timeout: 10 seconds
- Verify Mail Server Certificate: Default CA Certificate
- Authentication: Use Authentication
- User Name: adc.ps.email@gmail.com
- User Password: [Redacted]

A red box highlights the 'User Password' field, and a yellow callout bubble labeled 'App Password' points to it.